

CONFIRMAÇÃO DE FENÔMENS EM PRETO  
COR: 1 101 113 116 120 121 122 123 124 125 126 127 128 129 130 131 132 133 134 135 136 137 138 139 140 141 142 143 144 145 146 147 148 149 150 151 152 153 154 155 156 157 158 159 160 161 162 163 164 165 166 167 168 169 170 171 172 173 174 175 176 177 178 179 180 181 182 183 184 185 186 187 188 189 190 191 192 193 194 195 196 197 198 199 200

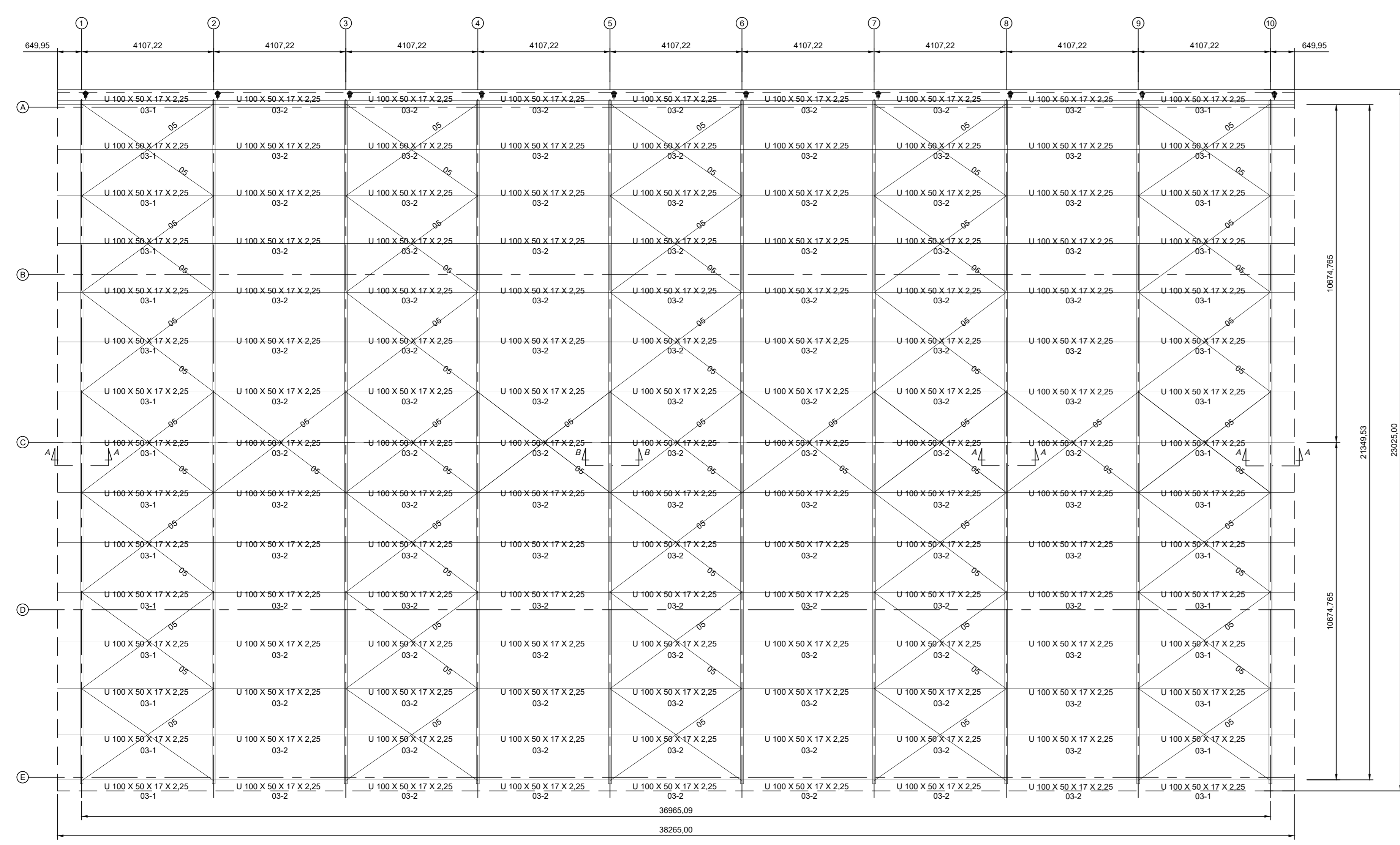

PLANO DA COBERTURA  
ESCALA: 1:100

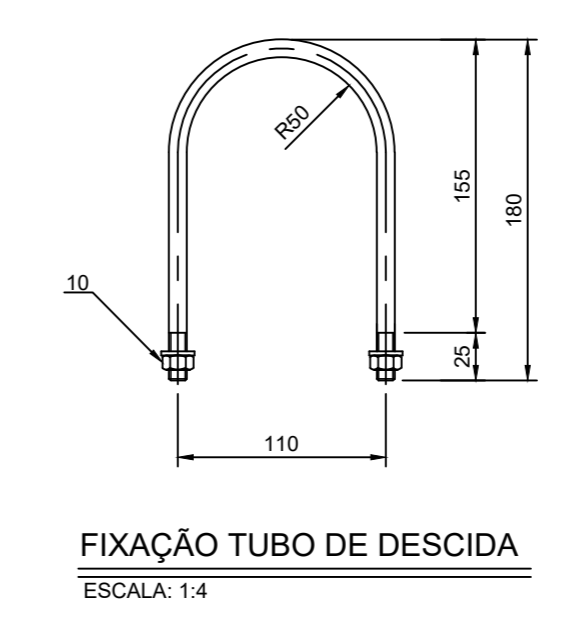
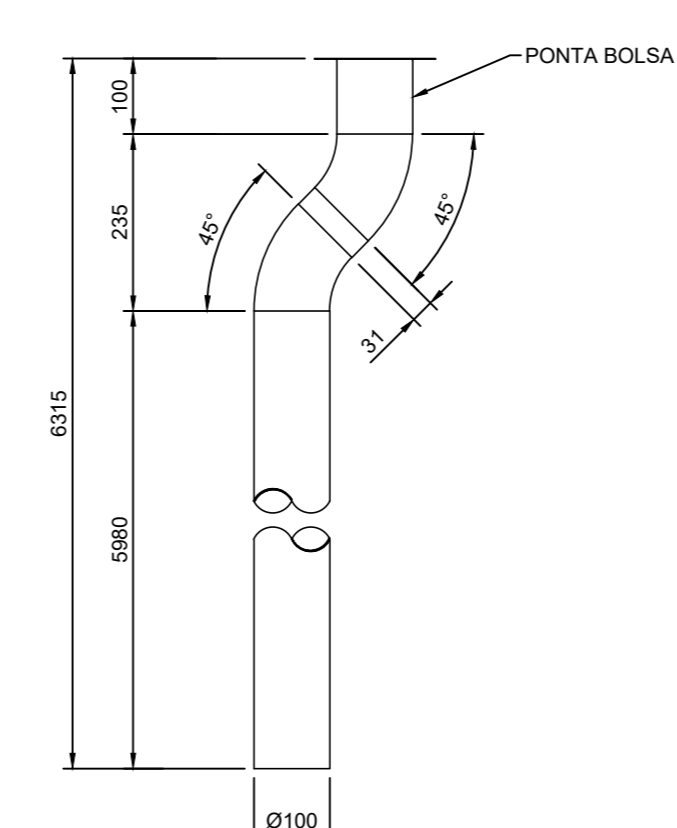
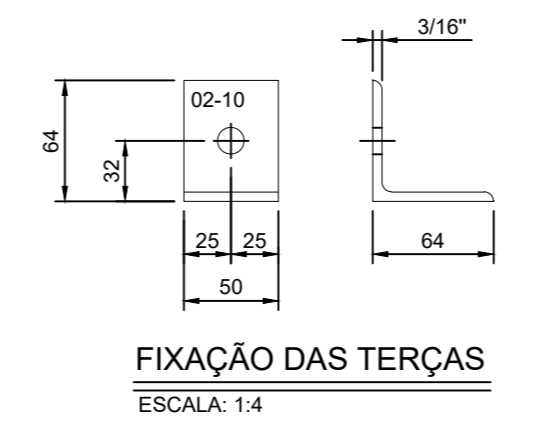
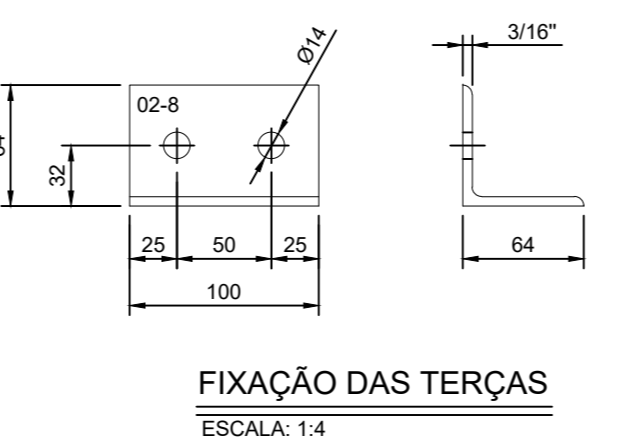
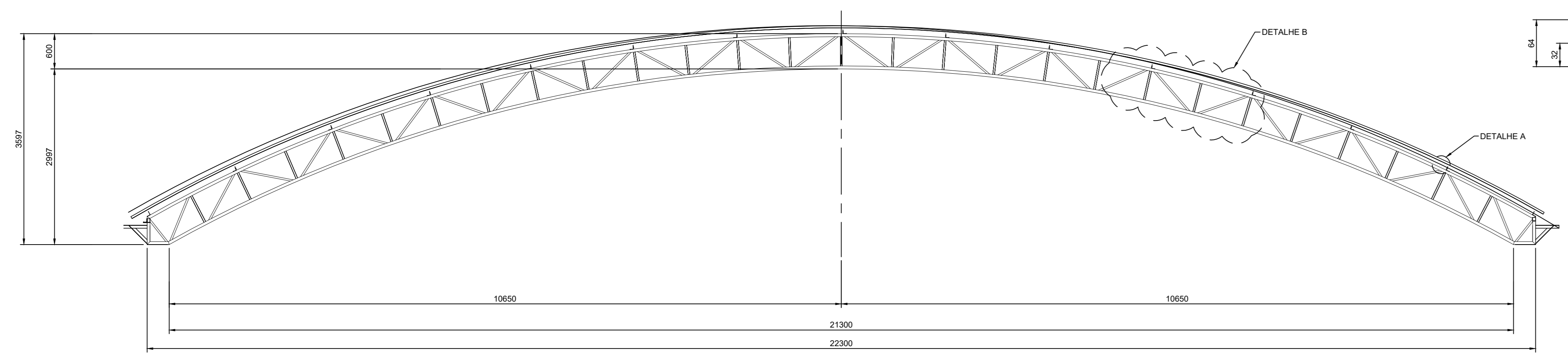
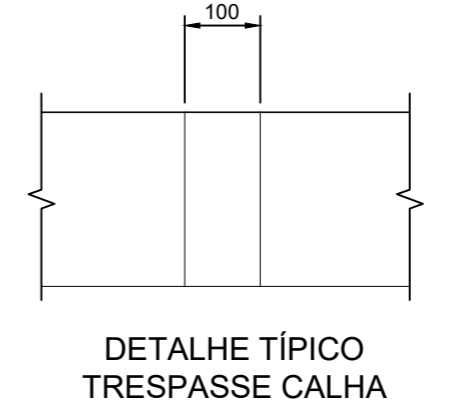
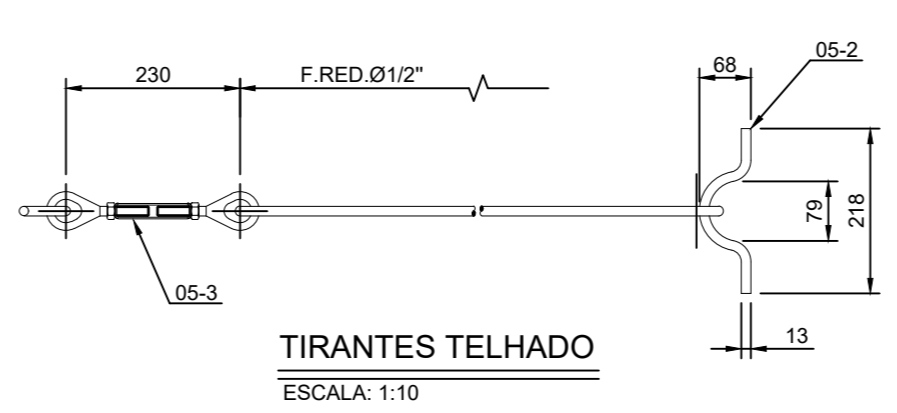
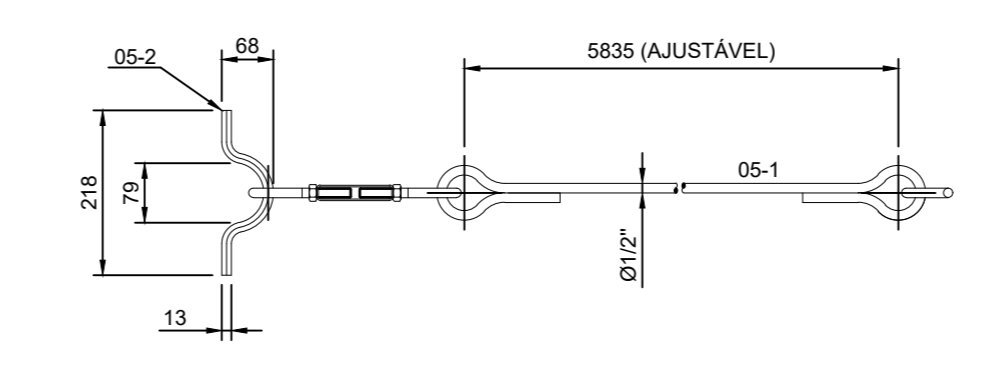
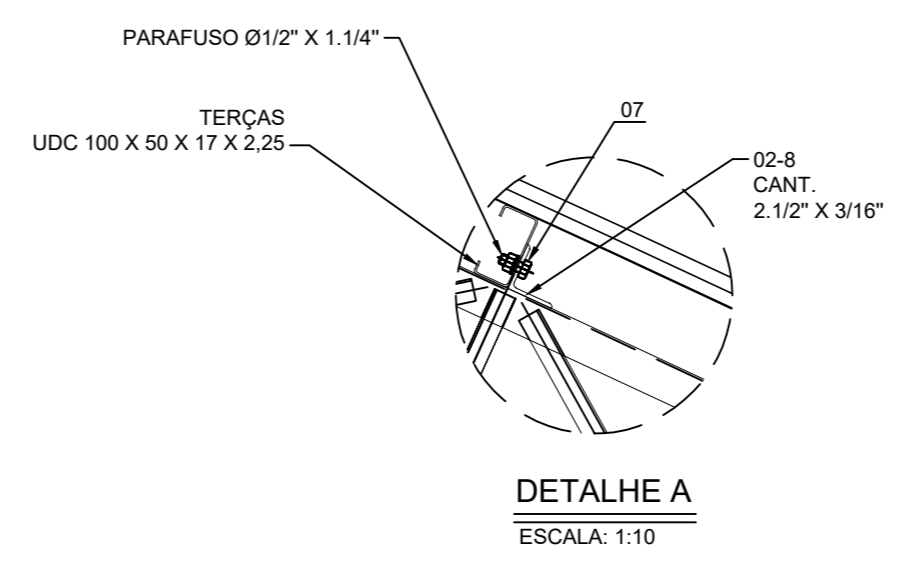
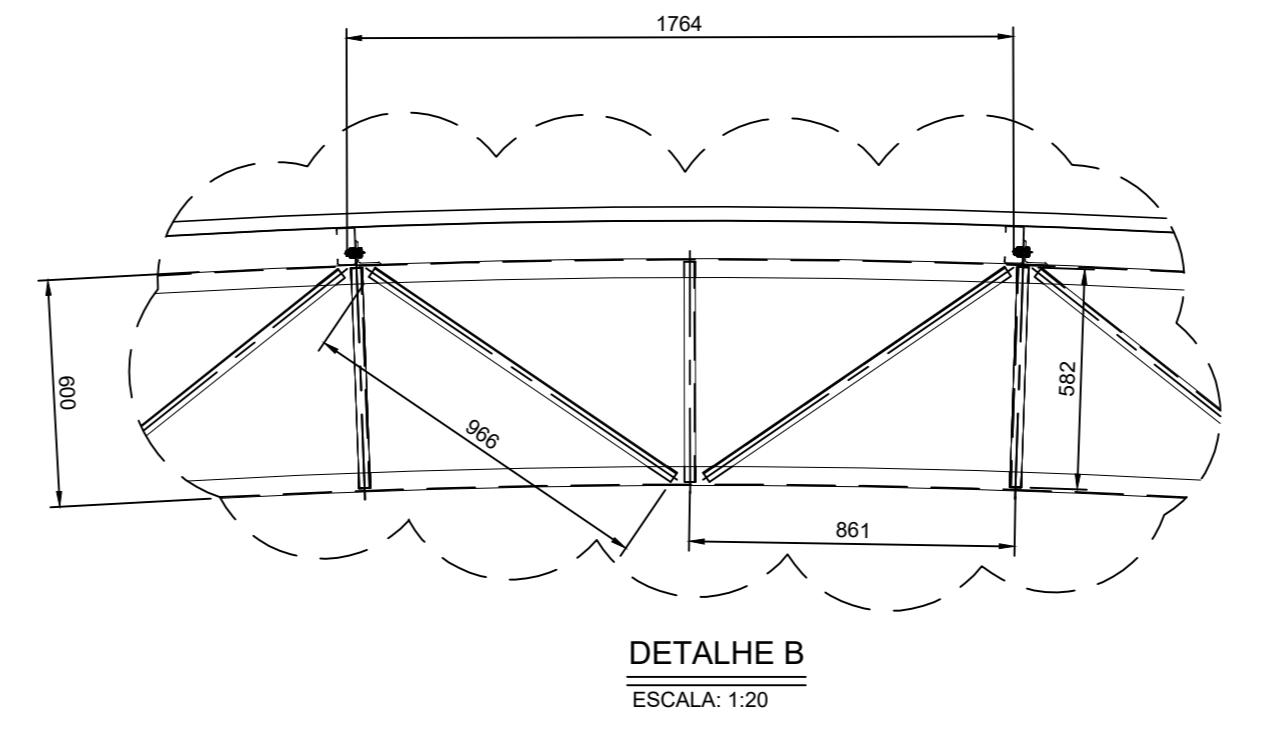
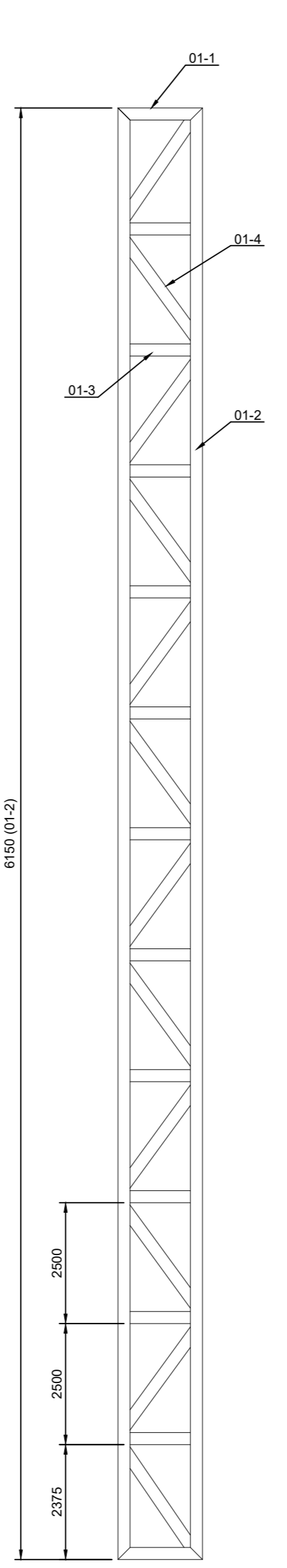
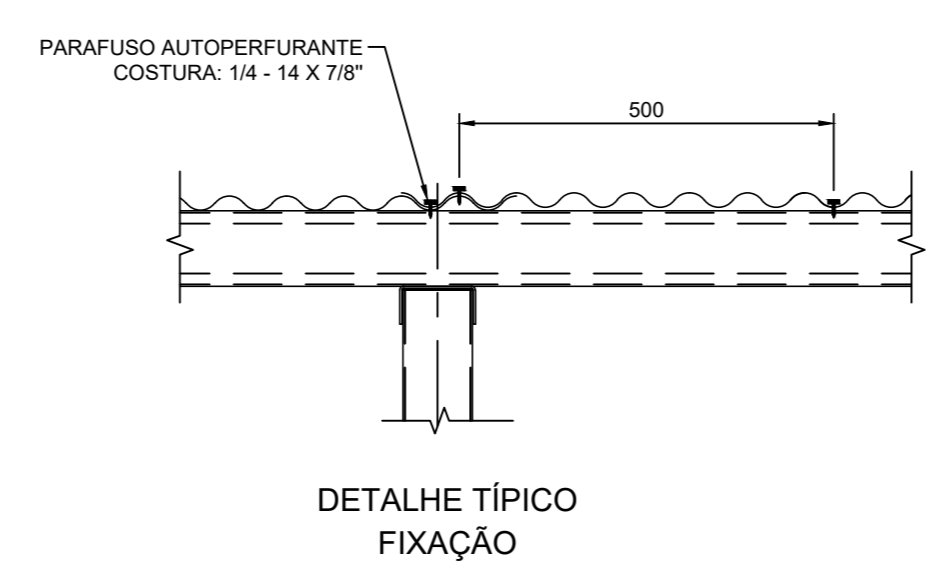
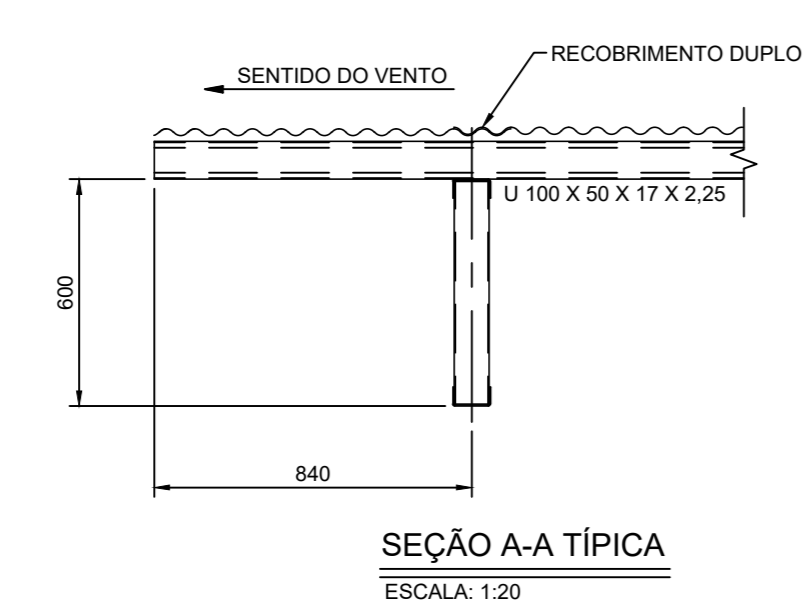
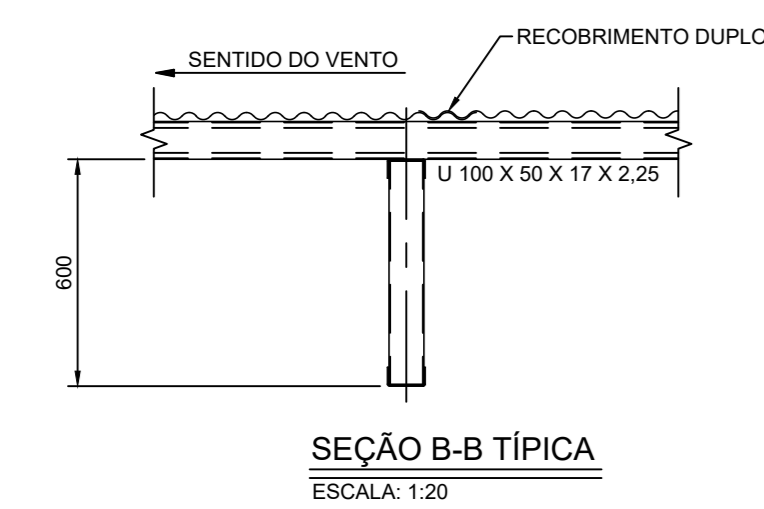

PERFIL U EM CHAPA DOBRADA U 100 X 50 X 2,25 BANZO SUPERIOR E INFERIOR  
PERFIL U EM CHAPA DOBRADA U 92 X 50 X 2,25 DIAGONAIS E MONTANTES  
PERFIL U EM CHAPA DOBRADA U 100 X 50 X 17 X 2,25 TERÇAS

NOTAS:  
1 - TODAS AS DIMENSÕES EM MILÍMETROS EXCETO INDICADO;  
2 - ESCALAS INDICADAS NOS DETALHES;  
3 - TODAS AS DIMENSÕES DEVERÃO SER AFERIDAS "IN LOCO" ANTES DA FABRICAÇÃO BEM COMO A LISTA DE MATERIAIS.

PESO TOTAL					34,642
08-2	ARRUELA LISA Ø3/8"		54	PÇ	0,007
08-1	PORCA SEXTAVADA Ø3/8"		54	PÇ	0,016
07-2	ARRUELA LISA Ø3/4"		200	PÇ	0,027
07-1	PORCA SEXTAVADA Ø3/4"		400	PÇ	0,070
--	ELEMENTOS DE FIXAÇÃO	--	--	PÇ	--

PESO TOTAL					204,60
06-3	TUBO DE DESCIDA EM PVC DN 100 x 6000	-	20	PÇ	-
06-2	F. RED. Ø3/8" x 415	ASTM - A36	24	PÇ	0,25
06-1	CH. GALVANIZADA 0,50 x 910 x 38625	ASTM - A36	02	PÇ	198,60
06	DRENAGEM PLUVIAL	ASTM - A36	--	PÇ	--

PESO TOTAL					476,00
05-3	ESTICADOR OLHAL-OLHAL / ROSCA 1/2" x CAIXA 9"	ASTM - A36	70	PÇ	0,40
05-2	F. RED. Ø1/2" 275 (29700mm TOTAL)	ASTM - A36	140	PÇ	0,30
05-1	F. RED. Ø1/2" 5835 (315090mm TOTAL)	ASTM - A36	70	PÇ	5,80
05	CONTRAVENTAMENTO	ASTM - A36	70	PÇ	--

PESO TOTAL					840,20
04-2	F. RED. Ø3/4" x 875 (140000mm TOTAL)	ASTM - A36	200	PÇ	1,96
04-1	CH. 6/8" x 600 x 250 (2,4m² TOTAL)	ASTM - A36	20	PÇ	22,41
04	CHUMBADORES	ASTM - A36	20	PÇ	--

PESO TOTAL					2466,60
03-2	P. UDC 100 x 50 x 17 x 2,25 x 4107,22 (431258,10mm TOTAL)	ASTM - A36	105	PÇ	17,56
03-1	P. UDC 100 x 50 x 17 x 2,25 x 5440 (163200mm TOTAL)	ASTM - A36	30	PÇ	20,76
03	TERÇAS	ASTM - A36	135	PÇ	--

PESO TOTAL					3445,80
02-10	CANTONEIRA 2" x 3/16" x 400 (3200mm TOTAL)	ASTM - A36	10	PÇ	1,45
02-9	CANTONEIRA 2" x 3/16" x 440 (3520mm TOTAL)	ASTM - A36	10	PÇ	1,60
02-8	CANTONEIRA 2.1/2" x 3/16" x 100 (20400mm TOTAL)	ASTM - A36	255	PÇ	0,40
02-7	P. UDC 92 x 30 x 2,65 x 966 (216384mm TOTAL)	ASTM - A36	280	PÇ	2,84
02-6	P. UDC 92 x 30 x 2,65 x 582 (125712mm TOTAL)	ASTM - A36	290	PÇ	1,70
02-5	P. UDC 92 x 30 x 2,65 x 582 (9312mm TOTAL)	ASTM - A36	20	PÇ	1,70
02-4	P. UDC 100 x 50 x 2,65 x 24872 (198976mm TOTAL)	ASTM - A36	10	PÇ	97,83
02-3	P. UDC 100 x 50 x 2,65 x 24000 (192000mm TOTAL)	ASTM - A36	10	PÇ	94,40
02-2	P. UDC 100 x 50 x 2,65 x 427 (6832mm TOTAL)	ASTM - A36	20	PÇ	1,68
02-1	P. UDC 100 x 50 x 2,65 x 448 (7168mm TOTAL)	ASTM - A36	20	PÇ	1,76
02	TESOURAS	ASTM - A36	10	PÇ	--

PESO TOTAL COBERTURA METALICA		
01	ELEMENTOS DE FIXAÇÃO	34,642 KG
02	CONTRAVENTAMENTO	476,00 KG
03	CHUMBADORES	840,20 KG
04	TERÇAS	2.466,60 KG
05	TESOURAS	3.445,80 KG
TOTAL		7.263,24 KG

**PREFEITURA MUNICIPAL DE FORMIGA**  
SECRETARIA DE OBRAS, TRANSPORTES E URBANISMO  
Rua: Cel. José Gonçalves D'Amorim, nº91 - Formiga - Conto - CEP: 35.570-146  
Fone: (37) 3328-1846

PROJETO: PROJETO ESTRUTURAL DE UMA COBERTURA DE QUADRA

SIC: OBRAS: EUGÊNIO VILELA PREFEITO MUNICIPAL  
PROJETO: TAMARA FERNANDES SILVA ENGENHEIRA CIVIL - CREA: 212.530/D

ESCALA: Indicada  
DATA: 15/03/2021  
DESENHO: 02/03

ÁREA A SER COBERTA: 881,05 m²  
LOCAL: Rua: José Cassiano Alves  
FOLHA: 02/03

FORMATO A1 ALCONG. - 1189x934 mm